

Tacx

Antares

Sestavení válců T1000

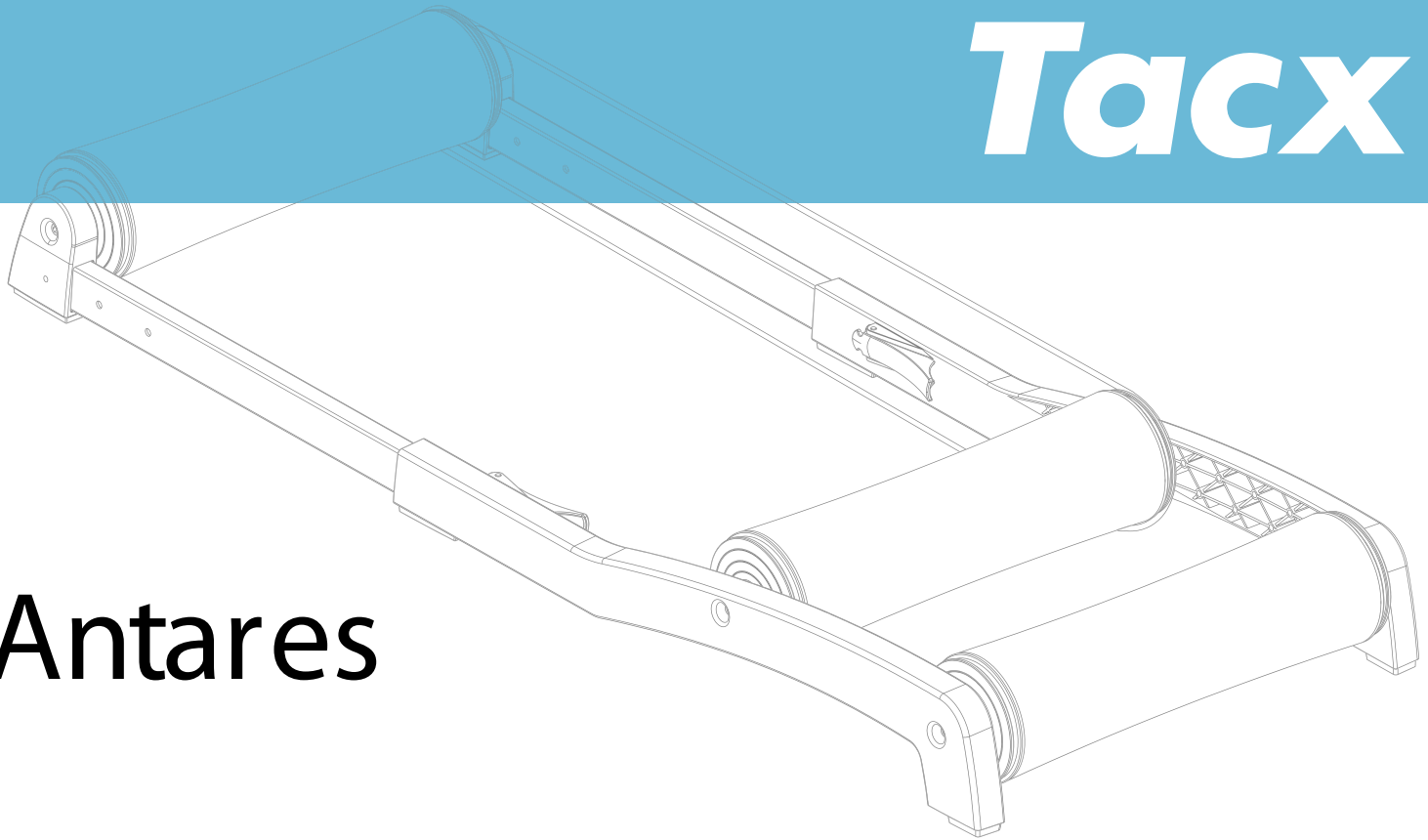

T1005 Součásti válců

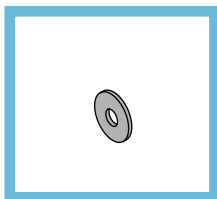

T1005.04 6x
Podložka M6



T1005.01 6x
Šroub M6x20

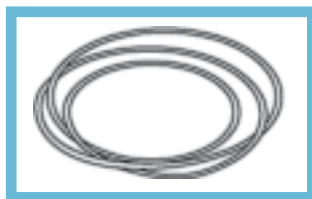

T1043 1x
Pás

Příbalené nářadí



T1005.03 2x
Imbusový klíč 5mm

1

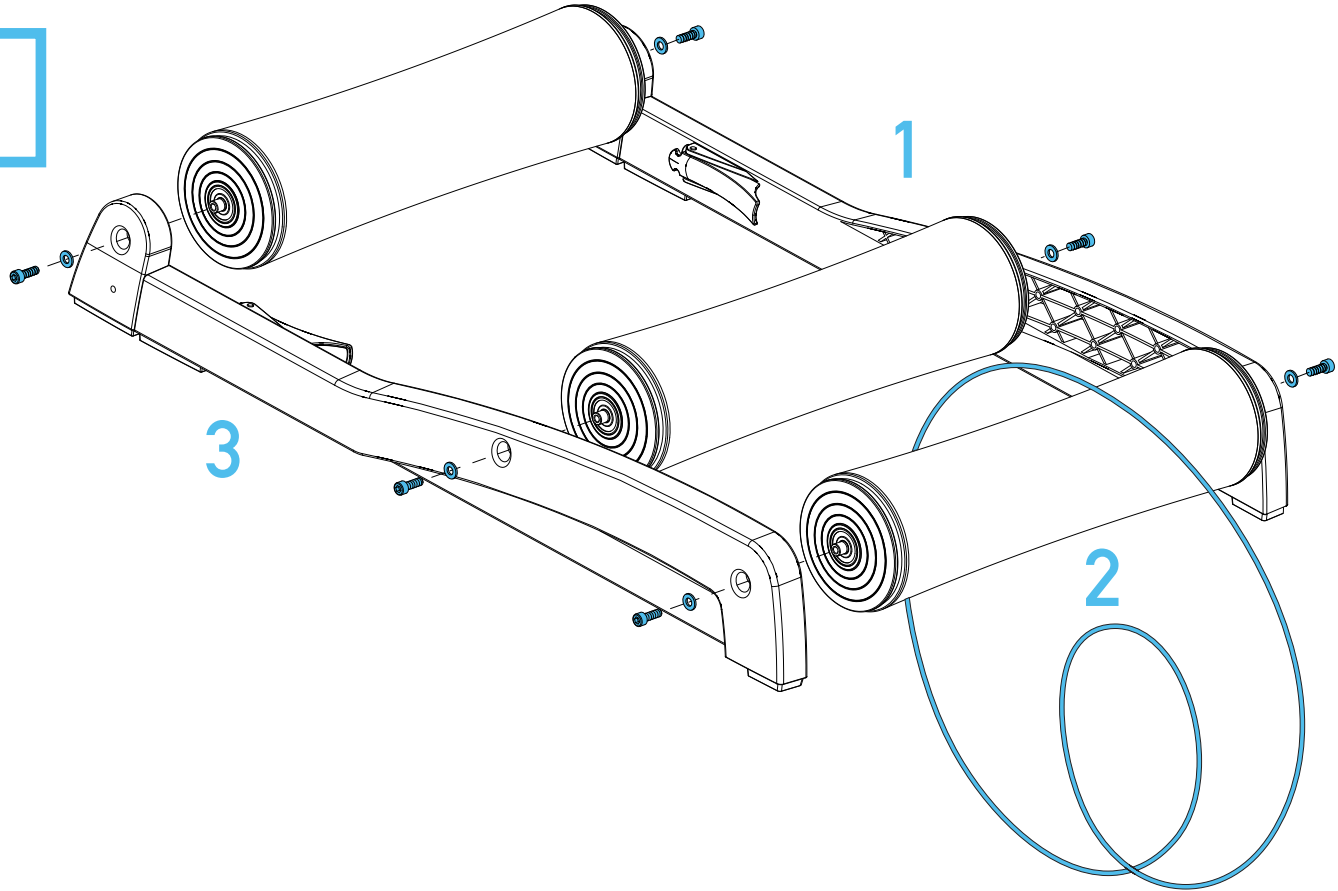

2

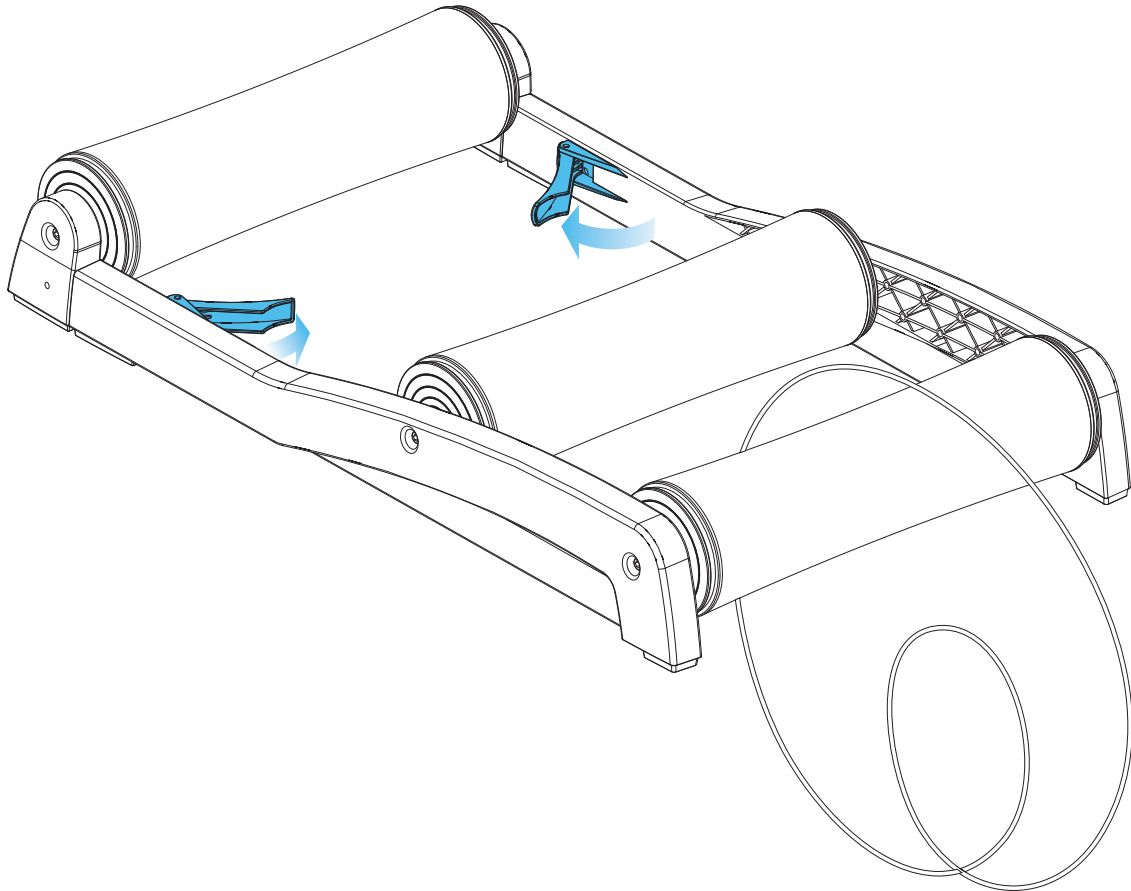

3

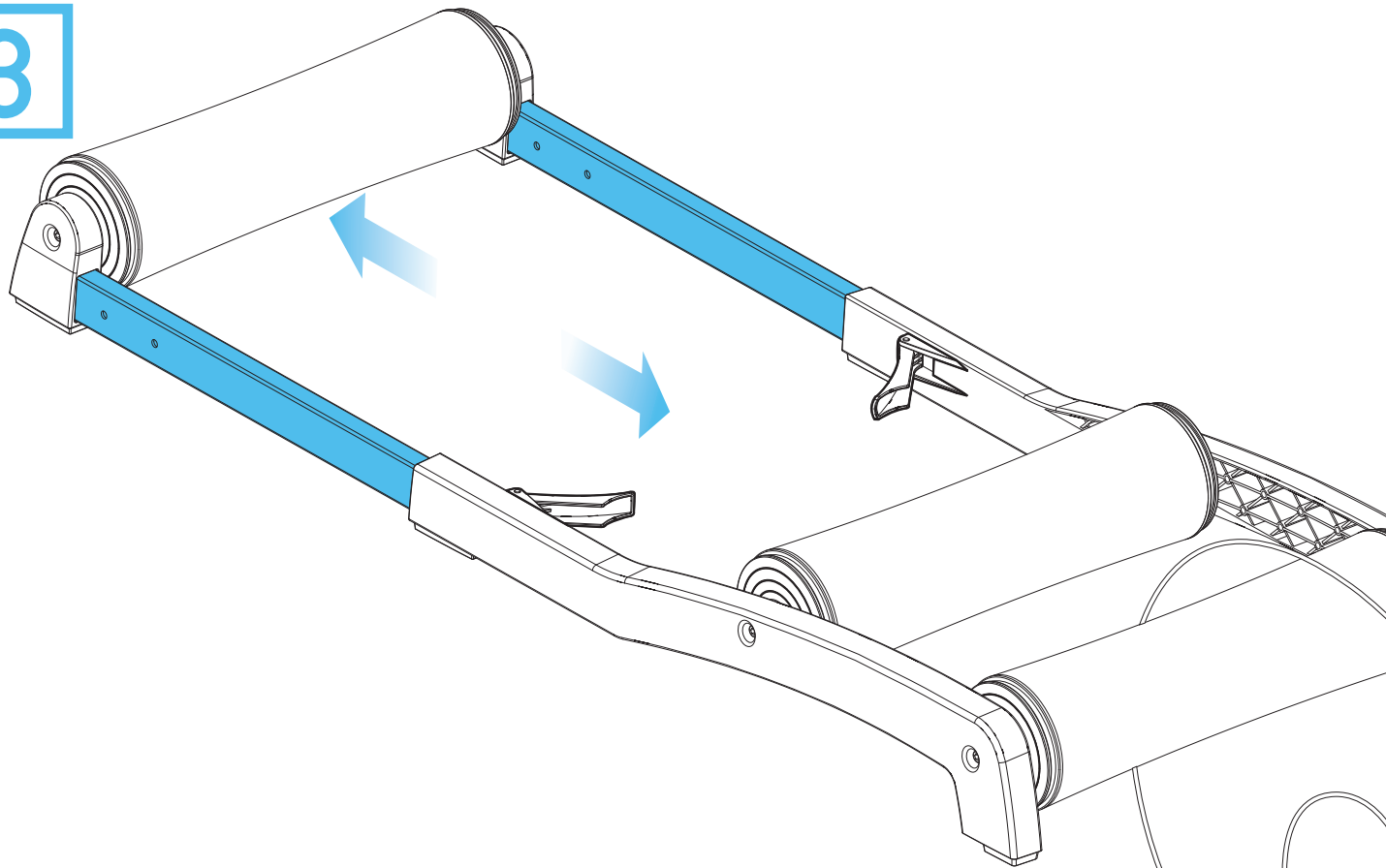

4

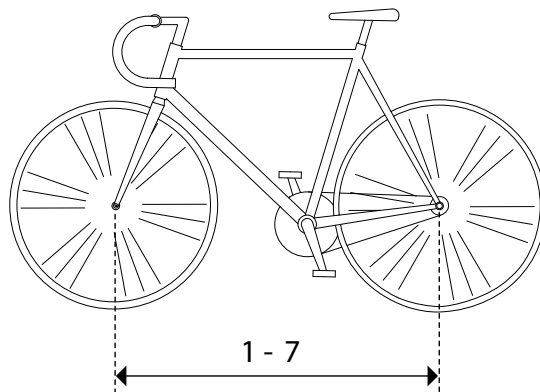

	max. mm	min. mm
1	1100	1080
2	1080	1060
3	1060	1040
4	1040	1020
5	1020	1000
6	1000	980
7	980	<980

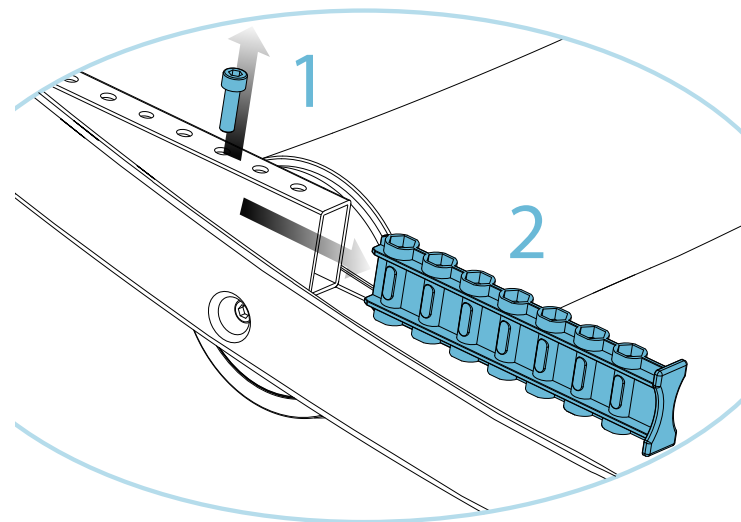

Pokud potřebujete změnit rozteč válců, otočte je obráceně, vyšroubujte šroub a dejte jej na jinou pozici. Standardně je rozteč válců nastavena na pozici 4.

